

HOW TO INSTALL YOUR HOT BUDDY

Operation and installation manual Sunwood Marino



SUNWOOD
DUTCH DESIGN

TABLE OF CONTENTS

Warranty	4
Warnings	5
Installation instructions	6
Operation manual	8
Maintenance	10

SPECIFICATIONS SUNWOOD MARINO

MODEL	Marino	GAS TYPE	G31
VERSION	Propane	INJECTOR	1,1 mm
LAND OF DESTINATION	England (UK)	PRESSURE	37 mbar
PIN NUMBER (CE)	0063CM3866	NOM. INPUT	5,71 kW
GAS CATEGORY	I3P		

WARRANTY

The Sunwood Marino comes with a 1 year warranty from the date of purchase.

If there appears to be material or manufacturing errors, the defects resulting from these errors shall be repaired or replaced by Sunwood. If a defect is not repaired a fitting compensation can be offered by Sunwood. The decision to replace, repair or otherwise provide compensation for a defect is taken at the sole discretion of Sunwood.

All warranty claims are expressly subject to the condition that the maintenance recommendations from Sunwood have been followed correctly and that the item is used exclusively under normal conditions. In addition, the condition that the product is solely used in the land of destination listed in this operation and installation manual and the product sticker also applies.

Warranty claims for defects/damages arising from inappropriate use, incorrect or injudicious use or from normal wear and tear are excluded from this coverage.

A warranty claim can only be made upon presentation of the original invoice, which must therefore be stored carefully. Only the original buyer may submit a warranty claim. The claim may only be submitted to the dealer from whom the product was originally purchased.

A warranty claim must first be assessed by Sunwood. The warranty does not automatically include reimbursement of the transport costs of defective products to the Sunwood factory or to the concerned dealer. The same applies to return shipments of replaced or repaired products. The repair itself is performed free-of-charge within the warranty period.

WARNINGS

READ THE MANUAL CAREFULLY BEFORE YOU USE THIS PRODUCT. NEVER THROW THE MANUAL AWAY.

- ▶ This product and the gas cylinder need to be installed as per instructions in this manual and conform any national and/or local regulations.
- ▶ The minimum distance between the product and flammable materials has to be 1,5 meter.
- ▶ Never leave the fire unattended.
- ▶ Do not move the Marino while in use.
- ▶ Keep the product out of reach for children when the fireplace is on, and until it's completely cooled down.
- ▶ Always close the gas cylinder before you move the product.
- ▶ Never try to repair this product yourself, and don't make modifications to this product.
- ▶ Never block the air to the burner and or injector.
- ▶ Never block the air to the gas cylinder housing.
- ▶ With strong wind, always put the product on the breaks, or move the product to a wind still place to prevent from falling over.
- ▶ The use of this product in a confined space is dangerous and strictly forbidden! The product is intended to be used outside or in a well ventilated area. An area is considered well ventilated when a minimum of 25% of the wall's surface is open. See image below.

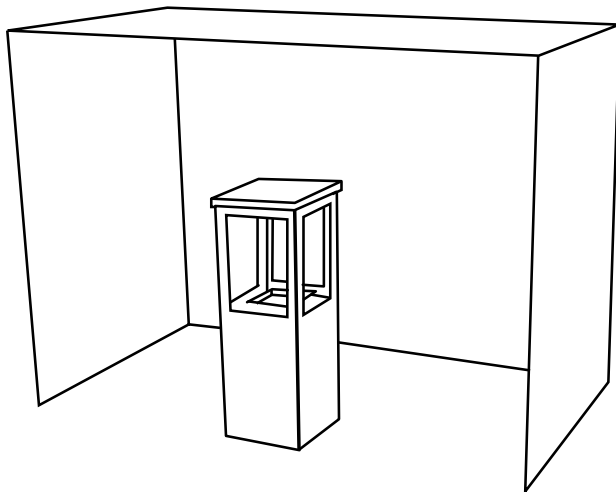

INSTALLATION INSTRUCTIONS

FOLLOW THESE STEPS WITH THE ILLUSTRATIONS ON THE RIGHT

Attention: When you need help to install the fire place, please contact your dealer.

STEP 1 ▶

Attach the wheels if desired. The correct mounting order seen from below is: bolt – wheel – Marino – washer – spring washer – nut. Use the included wrench to tighten.

STEP 2 ▶

Place the lava stones equally over the burner and the surrounding frame. While doing this make sure that as little dust as possible will get in to the burner.

STEP 3 ▶

Assemble the top of the Marino with the supplied screws. Use a phillips screwdriver to do this (not included in delivery).

STEP 4 ▶

Mount the pressure regulator on the gas cylinder with a good fitting wrench. Tighten it firmly, failing to do so will result in leakage and possibly dangerous situations. Change the gas cylinder only in a well ventilated space, and out of sight of candles, cigarettes, and other flammable products.

STEP 5 ▶

Always place the gas cylinder standing up. Don't let the hose contact any sharp objects or edges which may damage the hose.

STEP 6 ▶

Check all the connections on signs of leakage. You can do this by using soap or a gas leaking spray on the gas fittings / connections. If you notice any air bubbles then there is a leak.

WARNING

Check the hose at least once a month and every time you change the gas cylinder. If the hose contains any damage, it will need to be changed by a hose of the same length and quality.

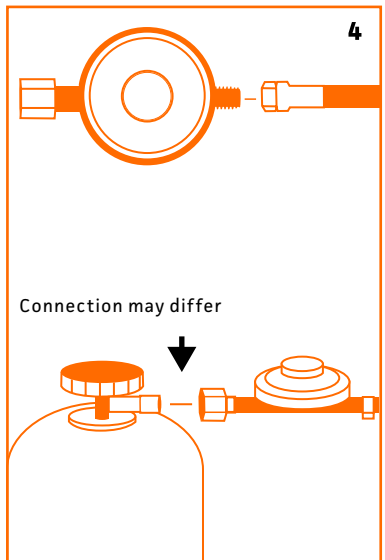
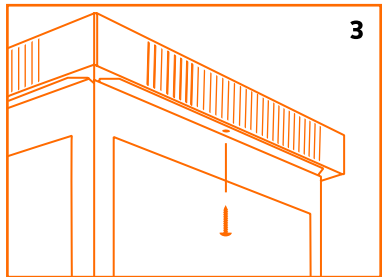
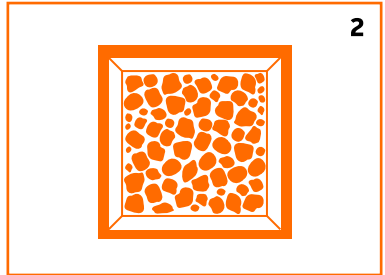
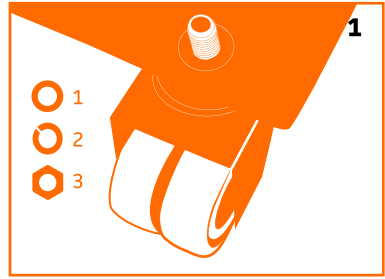
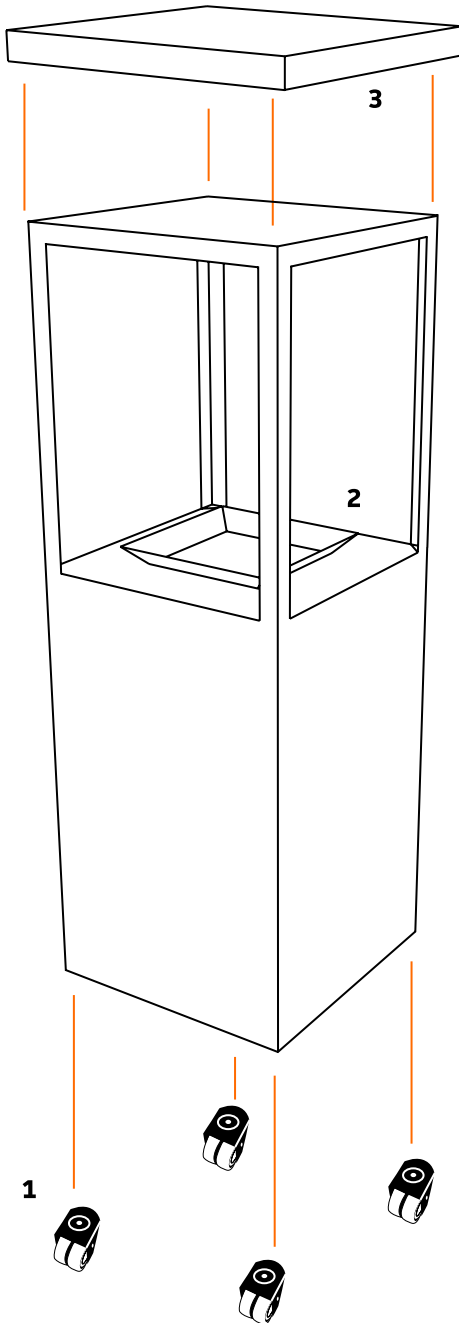

OPERATION MANUAL

FOLLOW THESE STEPS WITH THE ILLUSTRATIONS ON THE RIGHT

You operate the fire place with the gas control valve. You can find this valve behind the product's door.

Turning on

STEP 1 ▶	STEP 2 ▶	STEP 3 ▶
Push the control knob and turn to the ignition position. You will hear a click sound which is the spark to turn on the pilot burner.	When the pilot burner is on keep the control knob depressed for approximately 10 seconds. Then let go.	Repeat step one and two until the pilot burner does not go off when letting go of the button.

Adjusting the flames

STEP 1 ▶	STEP 2 ▶	STEP 3 ▶
You can set the flames to the desired position by turning the Flame Height Button.	Turn clock wise to set the fire to a lower position.	Turn counter clock wise to set the fire to a higher position.

Turning off

You turn the fireplace off by turning the control knob back to the same position as the image.

WARNING - WHAT TO DO WHEN YOU SMELL GASS

In the event of gas leakage, the appliance shall not be used or if alight, the gas supply shall be shut off and the appliance shall be investigated and rectified before it is used again. If necessary request your dealer for assistance.

When checking the appliance for leakage a soap solution should be applied directly on all connections / fittings to pin point the exact location of the leak.

Do not use the appliance again until all leaks are resolved.

WARNING

Check the hose at least once a month and every time you change the gas cylinder. If the hose contains any damage, it will need to be changed by a hose of the same length and quality.

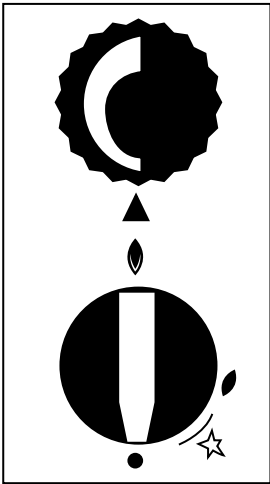
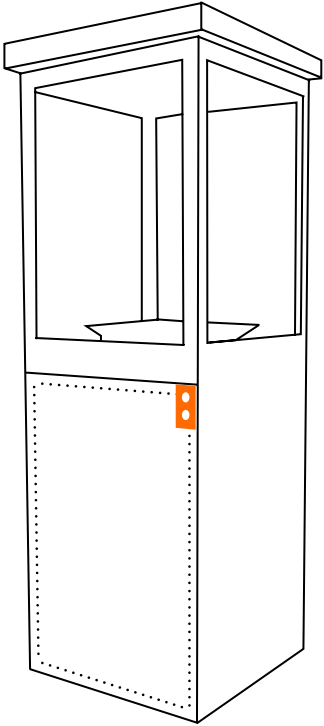

Gas control valve



Turning on



Adjusting the flames



Turning off

MAINTENANCE

Good maintenance of the Marino will significantly benefit the quality and lifetime of the product.

For the most optimal protection we suggest using the weatherproof protective cover (optional). It will keep the fire place nice and clean and ready to use. Beware that the fire has cooled down entirely before placing the cover over the Marino. If you do not use the Marino over a longer period of time, we suggest storing the fire inside or in a weatherproof space.

Despite the high quality finish and the use of high quality materials, the climate still affects the quality of the Marino. You can keep the Marino in top condition by protecting it as much as possible against weathering (such as sunbeams). Even though the fire has a UV-protection outer coating finish, this does not mean that the fire is entirely UV-proof. In order to prevent discolouration we suggest placing the Marino in an area free of direct sunlight (at least when it is not being used). This also applies to prevent discolouration of the protective cover.

You can clean the Marino with a moist cloth and a normal cleaner. The use of abrasive and aggressive cleaners must be avoided. Also avoid the use of micro fibre cloths. These deduce their cleaning capacity to the abrasive effect of the micro fibers. To clean the inside of the Marino you need to disassemble the roof first. Afterwards you can lift the glass panes, which will provide you with all space needed to clean the interior of the fire.

Replace the hose every 2 years and the pressure regulator every 5 years and make sure these meet all applicable national and regional regulations. The pressure regulator should provide the pressure mentioned in the specifications in the front of this manual. The use of an adjustable pressure regulator is forbidden.



Follow us on social media via
Facebook.com/[SunwoodNL](https://www.facebook.com/SunwoodNL) Instagram.com/[SunwoodNL](https://www.instagram.com/SunwoodNL) Twitter.com/[SunwoodNL](https://www.twitter.com/SunwoodNL)
and share your picture via Facebook, Instagram or Twitter with
[#sunwood](https://www.facebook.com/hashtag/sunwood) or [#sunwoodmarino](https://www.facebook.com/hashtag/sunwoodmarino)

Visit www.sunwood.nl for more information. Do you have questions? Mail to
sales@sunwood.nl or call **+31 (0)10 521 1325**



SUNWOOD
DUTCH DESIGN

www.sunwood.nl